

# JUNIPER COTTAGE

18 Eaton Road | Tarporley | CW6 0BP

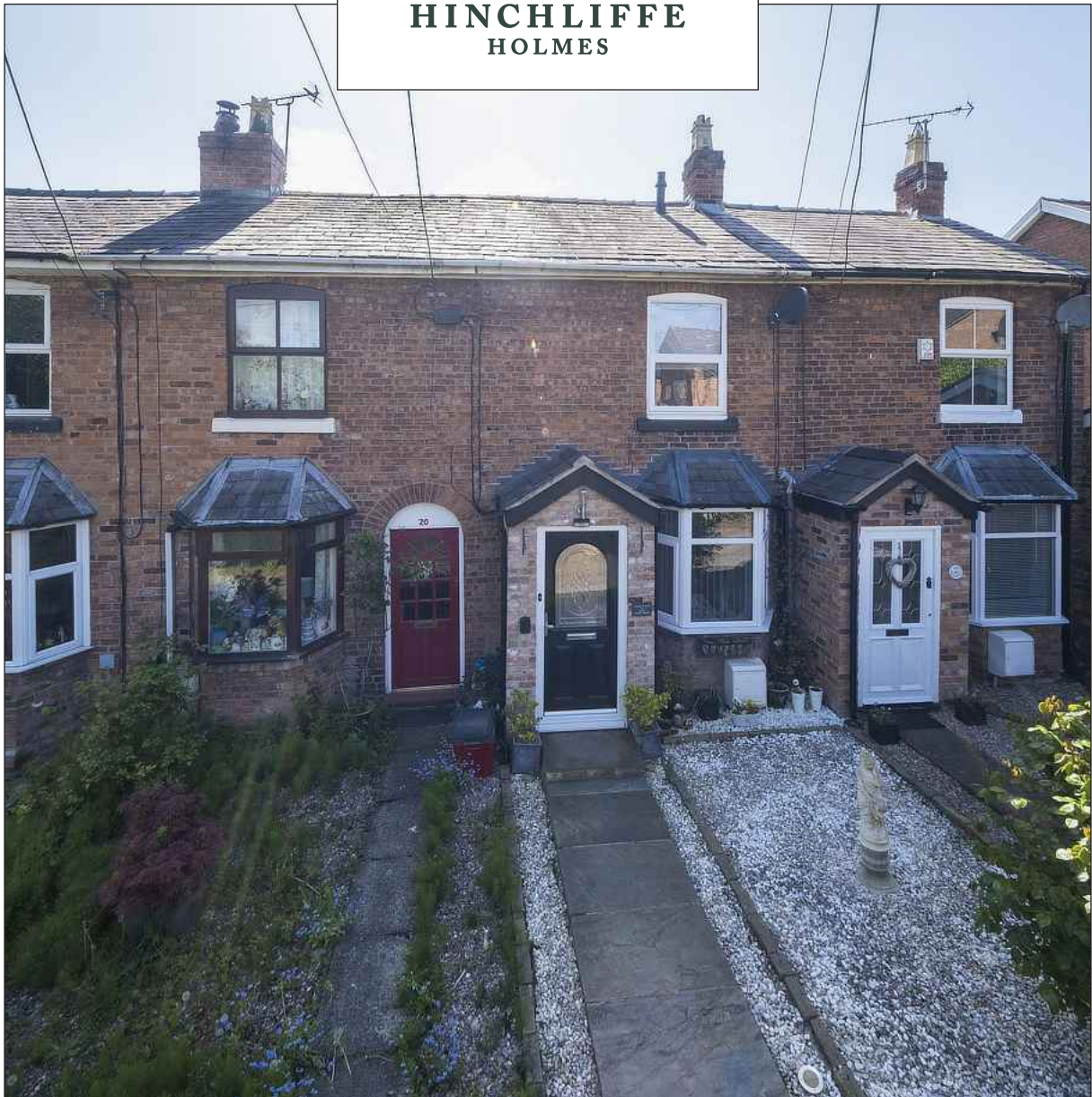

HINCHLIFFE  
HOLMES



*Situated in a sought-after quiet location within walking distance to the village centre and its amenities, a beautifully presented and fully modernised terrace cottage with open plan living accommodation. Low-maintenance landscaped garden and driveway providing off road designated parking for two vehicles.*



# JUNIPER COTTAGE

Situated in a sought-after quiet location within walking distance to the village centre and its amenities, a beautifully presented and fully modernised terrace cottage with open plan living accommodation. Low-maintenance landscaped garden and driveway providing off road designated parking for two vehicles.

The award-winning village of Tarporley, is renowned for its Historic High Street which is located approximately 12 miles from Chester and offers a superb range of amenities

including fashion boutiques, art galleries, DIY, florists, butcher, hairdressers, chemist, hospital, petrol station and other general stores. There is also a range of pleasant restaurants and public houses, which complete the thriving village. Additionally, Tarporley has the added benefit of two highly regarded Golf courses. Tarporley has its own two churches and both primary and secondary schools. There is easy access to the surrounding villages, motorway and railway networks, which give access to the north and south of the UK.

## GROUND FLOOR

Porch  
Lounge  
Kitchen

## FIRST FLOOR

Landing  
Bedroom One  
Bedroom Two  
Bathroom

## OUTSIDE

Parking  
Gardens















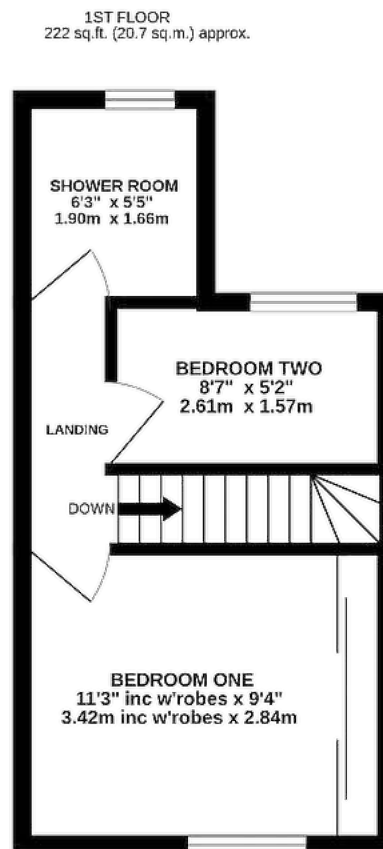
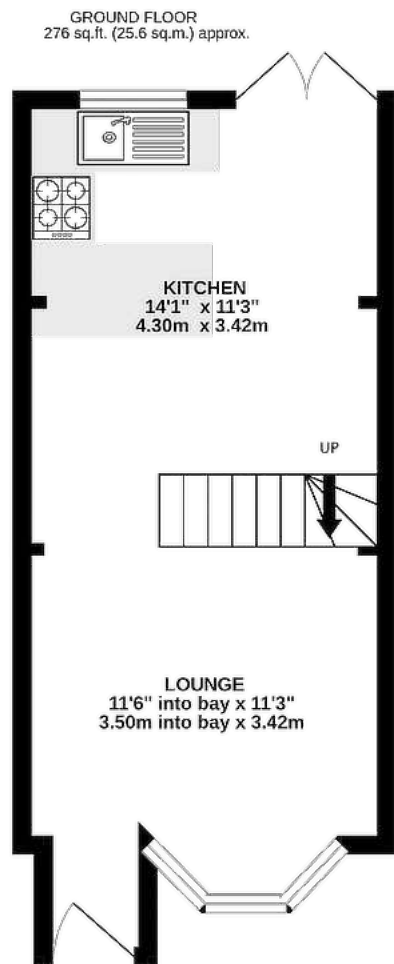

TOTAL FLOOR AREA: 498 sq.ft. (46.3 sq.m.) approx.



#### TENURE

Freehold. Subject to verification by Vendor's Solicitor.

#### SERVICES (NOT TESTED)

We believe that mains water, electricity, gas central heating and drainage are connected.

#### LOCAL AUTHORITY

Cheshire West And Chester. Council Tax – Band C.

#### POSSESSION

Vacant possession upon completion.

#### VIEWING

Viewing strictly by appointment through the Agents.

NOTICE: Hinchliffe Holmes for themselves and for the vendors or lessors of this property whose agents they are give notice that:

- (i) the particulars are set out as a general outline only for the guidance of intending purchasers or lessees, and do not constitute, nor constitute part of, an offer or contract;
- (ii) all descriptions, dimensions, references to condition and necessary permissions for use and occupation, and other details are given in good faith and are believed to be correct but any intending purchasers or tenants should not rely on them as statements or representations of fact but must satisfy themselves by inspection or otherwise as to the correctness of each of them;
- (iii) no person in the employment of Hinchliffe Holmes has any authority to make or give any representation or warranty whatever in relation to this property.
- (iv) Whilst every attempt has been made to ensure the accuracy of the floor plan contained here, measurements of doors, windows, rooms and any other items are approximate and no responsibility is taken for any error, omission, or mis-statement. This plan is for illustrative purposes only and should be used as such by any prospective purchaser. The services, systems and appliances shown have not been tested and no guarantee as to their operability or efficiency can be given.

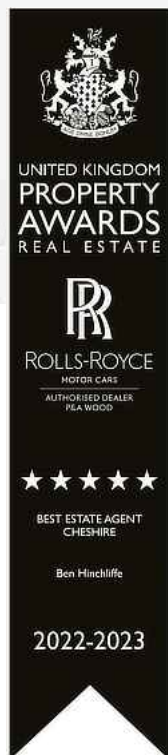
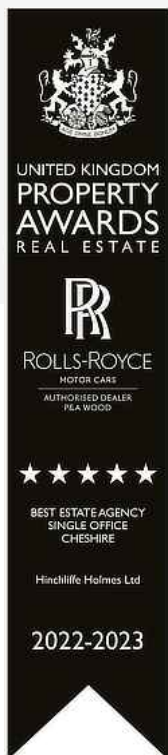
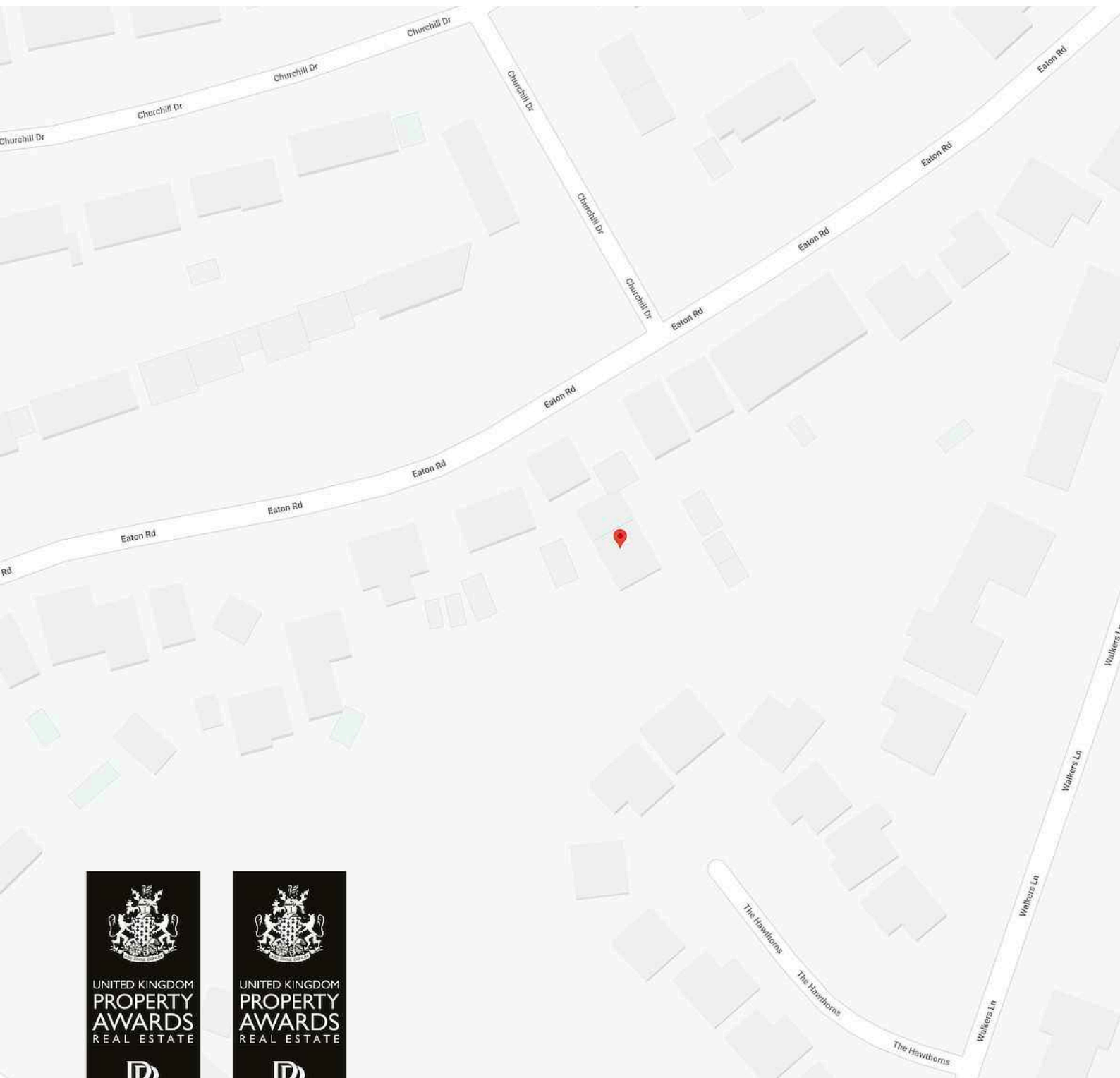

# LETTINGS

With our bespoke and personal approach, Hinchliffe Holmes has a tailored range of services to suit your needs as a Landlord. Our expert team will showcase your property to thousands of potential tenants each month.



Let Only  
Rent Collect  
Managed  
Complete Managed

# MORTGAGES

The Hinchliffe Holmes team is committed to providing the best possible service and advice. Our team of skilled and caring advisors will guide you through the mortgage application, removing the stress and simplifying the whole process.



Remortgage  
Commercial - Buy-to-let  
First time Buyer - Next Time Buyer  
Fixed Rate - Flexible - Tracker - Discounted

# LAND & NEW HOMES

The team at Hinchliffe Holmes offer experienced and professional advice for the purchase and sale of land, property development and the purchase of newly built and developed property.



An Exclusive Listing is a home sale that is not listed on the open market and therefore it is sold off-market using more private and discrete methods.

# EXCLUSIVE LISTINGS

Your home is one of a kind, the process of selling should be unique to you and your needs. Not all home sellers follow the traditional route when putting their home on the market. For some, an Exclusive Listing, can be the right method to sell their home.



**HINCHLIFFE  
HOLMES**

**INDEPENDENT ESTATE AGENTS**

**SALES | LETTINGS | MORTGAGES  
LAND & NEW HOMES | PROPERTY MANAGEMENT**

**TARPORLEY OFFICE**

56B High Street, Tarporley, Cheshire, CW6 0AG  
01829 730 021 - [tarporley@hinchliffeholmes.co.uk](mailto:tarporley@hinchliffeholmes.co.uk)

**NORTHWICH OFFICE**

28 High Street, Northwich, Cheshire, CW9 5BJ  
01606 330 303 - [northwich@hinchliffeholmes.co.uk](mailto:northwich@hinchliffeholmes.co.uk)

[www.hinchliffeholmes.co.uk](http://www.hinchliffeholmes.co.uk)